



Border Dripline Layouts



On more complex beds the dripline is still run in a grid format, with the first line 0.25 - 0.3m from the edge and each subsequent line 0.5m - 0.6m apart. Use barbed tee pieces (FBT16) to branch.

Either use hose to bring a temporary supply to the bed or use 20mm underground pipe to bring a permanent supply to the border.

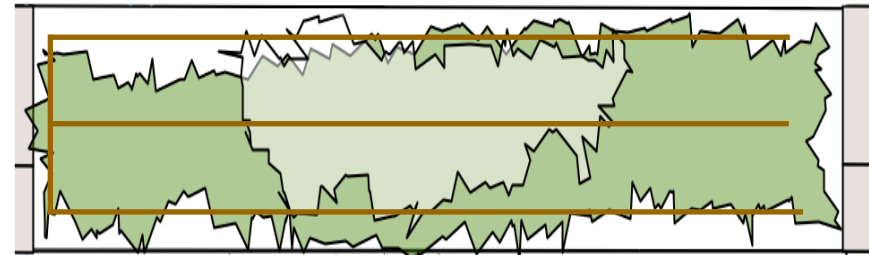

On rectangular beds the dripline is run in a grid format, with the first line 0.25 - 0.3m from the edge and each subsequent line 0.5m - 0.6m apart. Use soil pegs (ESS16) every meter to secure.

Either use hose to bring a temporary supply to the bed or use 20mm underground pipe to bring a permanent supply to the border.



Grid layout



Anchorage Peg



TJ16 fold over stop end

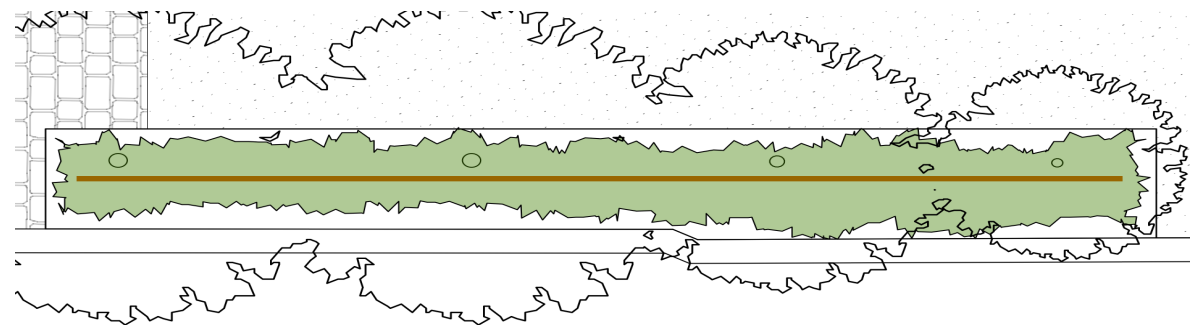

Hedge Runs

A single line of 0.3m spaced dripline (TNT0.3) is run down the length of the hedge. Peg every meter with soil stakes (ESS16). Max run: 185m with a 3.5 bar inlet pressure.