

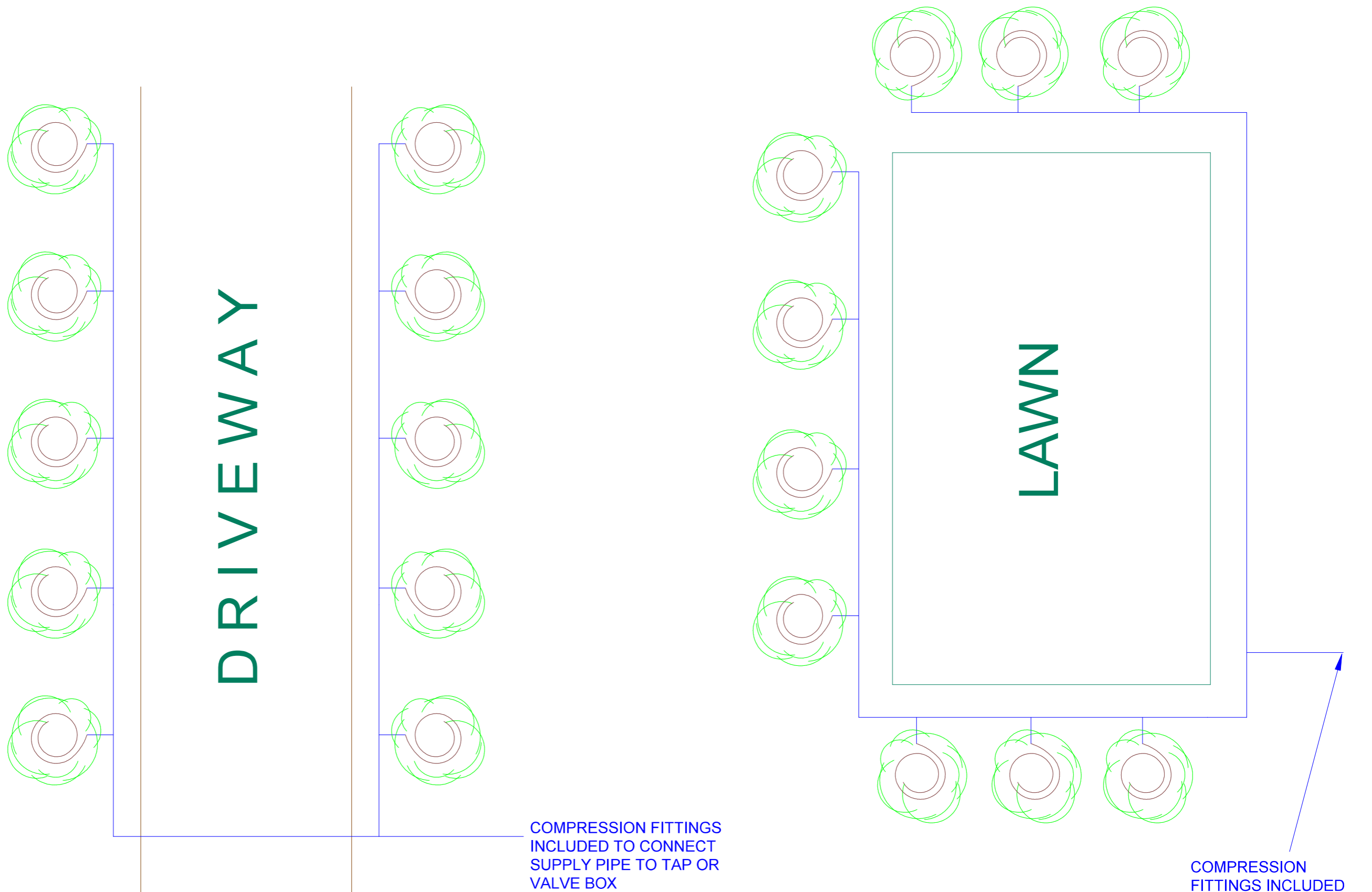

Do not scale off this drawing
All dimensions should be checked on site
E. & O.E.

© ACCESS IRRIGATION LTD



KEY

- = 20MM MDPE UNDERGROUND SUPPLY PIPE - RUN TO TREE TAKE OFF POINTS
USE 20MM COMPRESSION TEES TO TEE OFF TO EACH TREE
- = TREE DRIPLINE - RUN IN RINGS AROUND EACH TREE BASE AS PER DRAWING

Title:	TREE DRIPLINE SYSTEM - SMALL	
Drawing No:	DR019	Rev: 1